

Connector - C-SCFI 1,5/2,8X0,5 - 3240048

Please be informed that the data shown in this PDF Document is generated from our Online Catalog. Please find the complete data in the user's documentation. Our General Terms of Use for Downloads are valid (<http://phoenixcontact.com/download>)



Slip-on sleeve, red, 0.5 ... 1.5 mm², 2.8 x 0.5

Your advantages

- ✓ Hard-soldered crimping zone for maximum pull-out forces
- ✓ Electrolytic tin plating
- ✓ Halogen-free
- ✓ 'EASY ENTRY' for easy and reliable conductor entry



Key Commercial Data

Packing unit	1 pc
Minimum order quantity	100 pc
GTIN	 4 046356 452663
GTIN	4046356452663
Weight per Piece (excluding packing)	0.674 g
Custom tariff number	85366990
Country of origin	China

Technical data

Dimensions

Length (b)	18.5 mm
Width (a)	2.8 mm
Maximum stripping length	7 mm
Length of insulation sleeve (c)	10.5 mm

Connector - C-SCFI 1,5/2,8X0,5 - 3240048

Technical data

Dimensions

Inner dimension of the insulating collar (d)	4.1 mm
Material thickness (g)	0.25 mm

Ambient conditions

Ambient temperature (operation)	-20 °C ... 105 °C
---------------------------------	-------------------

General

Color	red
Stripping length	7 mm
Components	halogen-free
Material	Brass
Insulating material	PA
Coating	tin-plated

Standards and Regulations

Flammability rating according to UL 94	V2
--	----

Environmental Product Compliance

China RoHS	Environmentally friendly use period: unlimited = EFUP-e
	No hazardous substances above threshold values

Drawings

Dimensional drawing

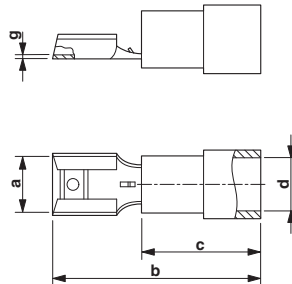

Classifications

eCl@ss

eCl@ss 10.0.1	27400204
eCl@ss 11.0	27400204
eCl@ss 4.0	27060700
eCl@ss 4.1	27060700

Connector - C-SCFI 1,5/2,8X0,5 - 3240048

Classifications

eCl@ss

eCl@ss 5.0	27400200
eCl@ss 5.1	27400200
eCl@ss 6.0	27400200
eCl@ss 7.0	27400204
eCl@ss 9.0	27400204

ETIM

ETIM 2.0	EC000005
ETIM 3.0	EC000005
ETIM 4.0	EC001052
ETIM 6.0	EC001052
ETIM 7.0	EC001052

UNSPSC

UNSPSC 6.01	30211923
UNSPSC 7.0901	27121703
UNSPSC 11	27121703
UNSPSC 12.01	27121703
UNSPSC 13.2	27121707
UNSPSC 18.0	27121707
UNSPSC 19.0	27121707
UNSPSC 20.0	27121707
UNSPSC 21.0	27121707

Accessories

Accessories

Crimping tool

Crimping pliers - CRIMPFOX-RCI 2,5 - 1212053



Crimping pliers, for insulated cable lugs, 0.5 mm² ... 2.5 mm² (red, blue), oval crimp

Connector - C-SCFI 1,5/2,8X0,5 - 3240048

Accessories

Crimping pliers - CRIMPFOX-RCI 2,5-M - 1212728



Crimping pliers, compact pliers, for insulated cable lugs (red, blue), two marked die stations, unlockable pressure lock, lateral entry

Crimping pliers - CRIMPFOX-RCI 6 - 1212057



Crimping pliers, for insulated cable lugs, 0.5 mm² ... 6.0 mm² (red, blue, yellow), oval crimp, symmetrical

Crimping pliers - CRIMPFOX-RCI 6-1 - 1212059



Crimping pliers, for insulated cable lugs, 0.5 mm² ... 6.0 mm² (red, blue, yellow), oval crimp, asymmetrical

Crimping pliers - CRIMPFOX-RCI 6-M - 1212730



Crimping pliers, compact pliers, for symmetrical insulated cable lugs, 0.5 mm² ... 6.0 mm² (red, blue, yellow), three marked die stations, unlockable pressure lock, lateral entry

Die

Replacement die - CF 500/DIE RCI 1,5 - 1212263



Die for crimping machine CF 500, for insulated cable lugs (C-RCI... and C-FCI...) 0.14 ... 1.5 mm²

Connector - C-SCFI 1,5/2,8X0,5 - 3240048

Accessories

Replacement die - CF 500/DIE RCI 6 - 1212240



Die for crimping machine CF 500, for insulated cable lugs (C ... RCI... and C ... FCI...) 0.5 ... 6 mm²